

# HOOK-LOC Base Microwave Cabinet Assembly

Step1: With face of cabinet laying down, Slide end panels into hook groove on Face frame till side panel and face frame even.

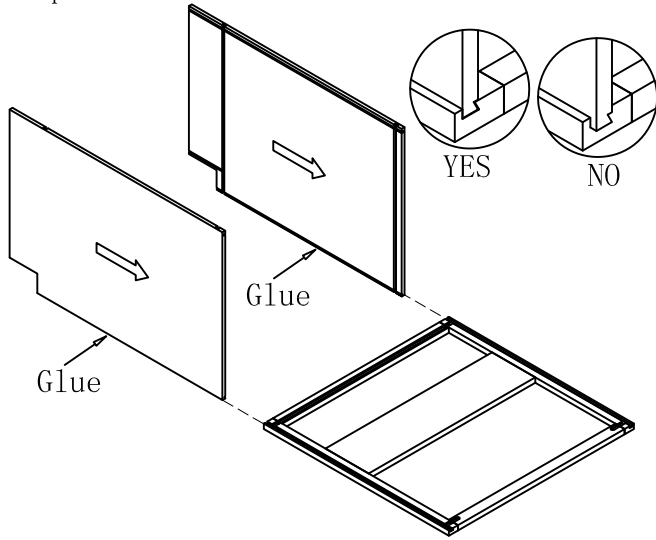

Step2: Slide I-Beams into slot of side panel till they lock into groove in Face Frame.

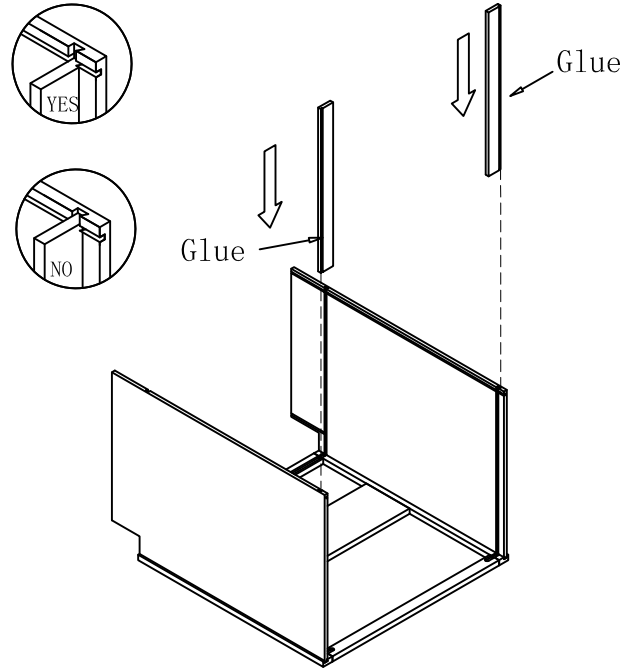

Step3: Slide Bottom into hook groove in sides of the cabinet.

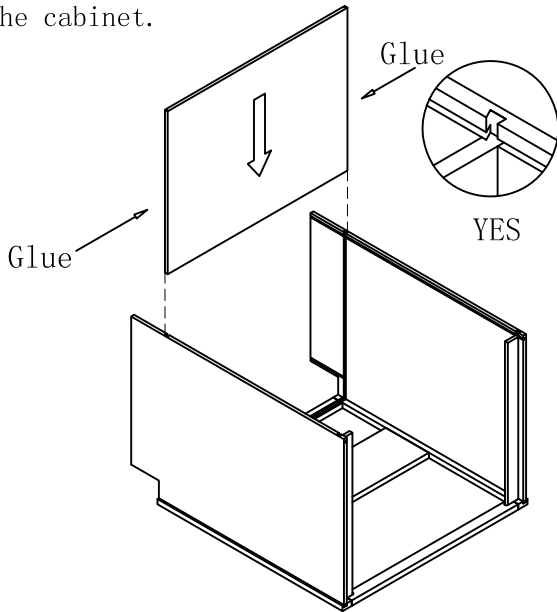

Step3: ① Lightly push side panels apart ② to allow hanging rail ③ to lock into groove on end panels

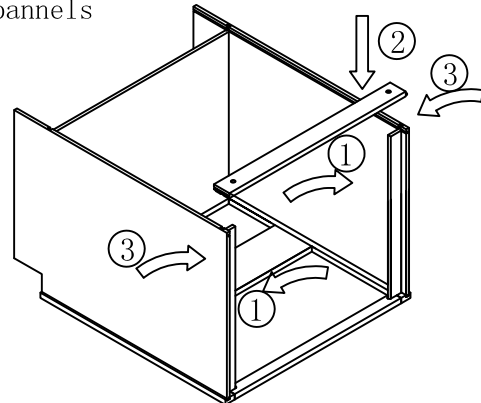

Step4: Install screws into rail. Slide Back Panel into slot.

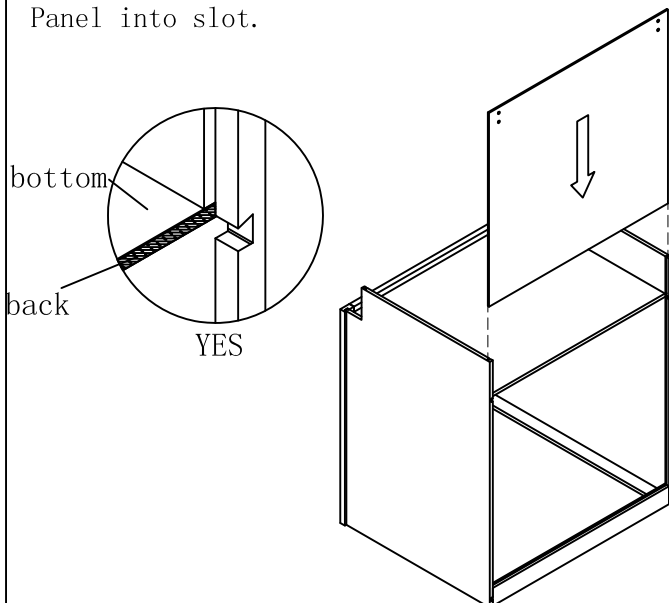

Step5: Install bottom hanging rails.

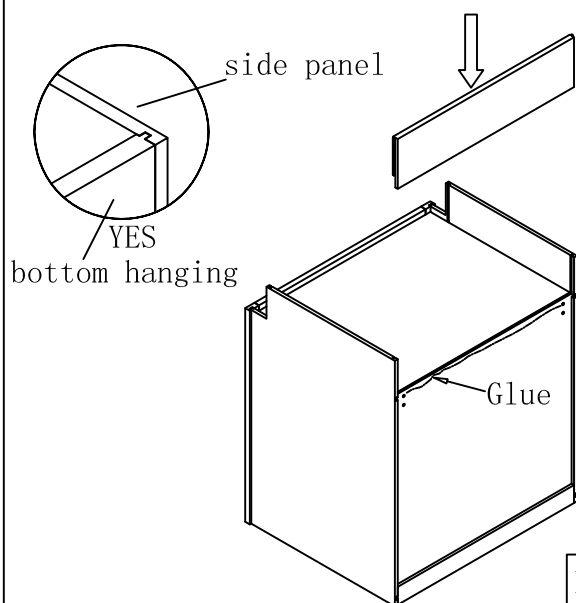

# HOOK-LOC Base Microwave Cabinet Assembly

Step6:Slide toe kick backer into cabinet grove.

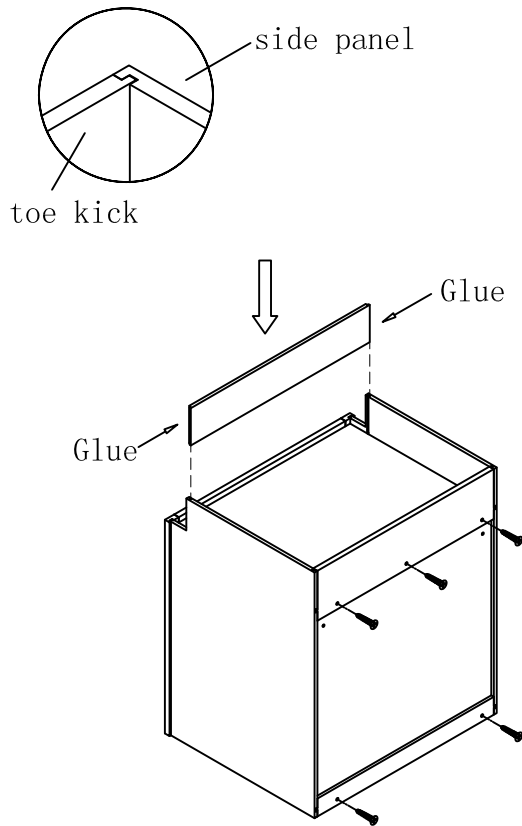

step7:Install rail in the middle of the bottom panel

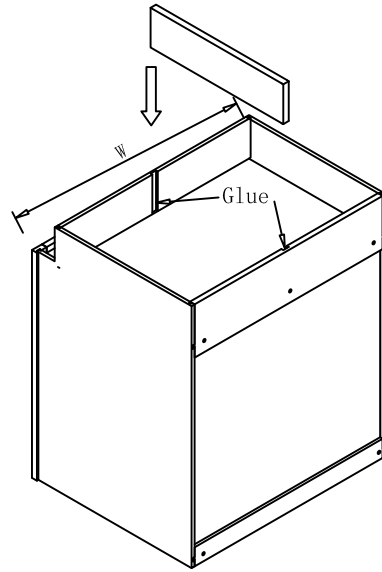

Step8:this is an adjustable shelf install as need with your oven, Install the screws into wood blocks on the face frame and side panel and back panel.

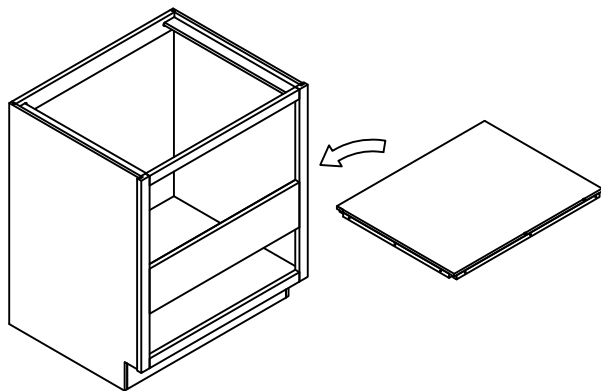
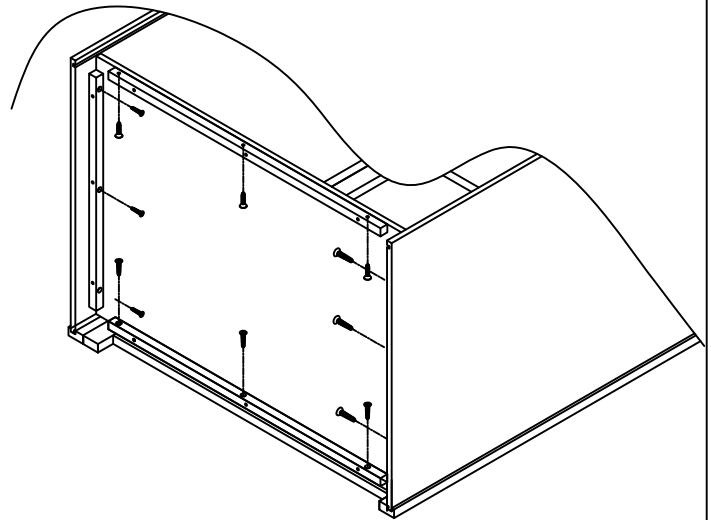

Step9:

- Install drawers
- Clean any excess glue.
- Proceed to install drawer track

